

Tailgate Latch/Fuel Lid Opener Cable

Tailgate Lock Replacement

1. Remove the tailgate lower trim panel (page 14-17).

2. To remove the outside handle, first remove the:

- License light covers
- Wiper arm (See section 16)
- Wiper motor (See section 16)

3. To remove the tailgate latch assembly, first disconnect the rod and connector.

NOTE: To ease reassembly, note the location **A** of the rod on the joint before disconnecting it.

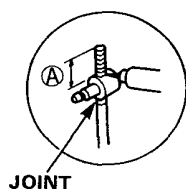

TAILGATE LOCK CYLINDER
Remove the tailgate lock cylinder by turning it right.

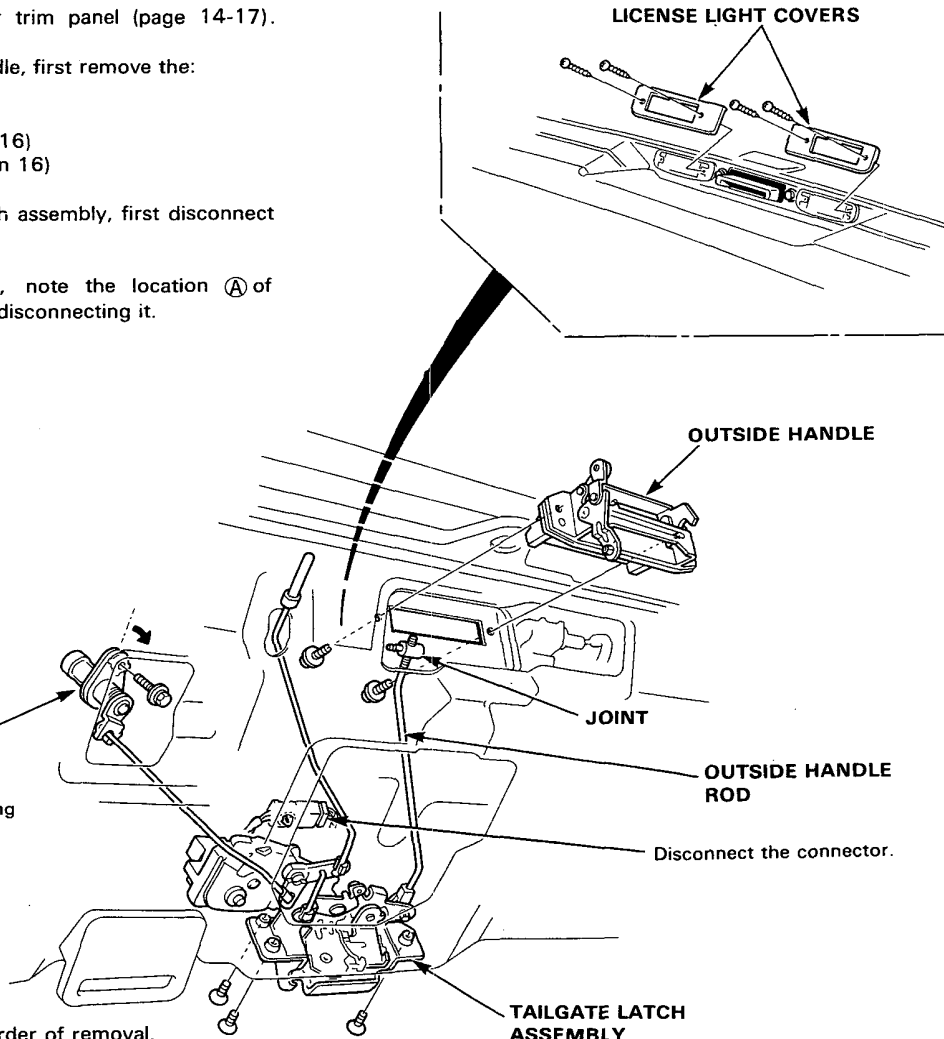

4. Installation is the reverse order of removal.

NOTE: After installing, check that the tailgate latch is operated properly.

Fuel Lid Opener Cable Replacement

Fuel lid opener cable is routed and connected properly as shown.

NOTE: Take care not to bend the cable.

→: Clip locations

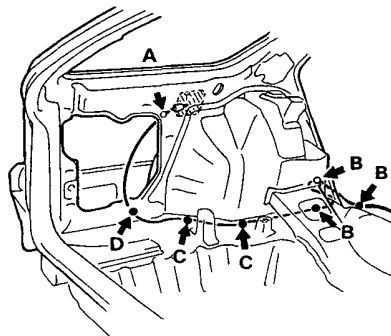
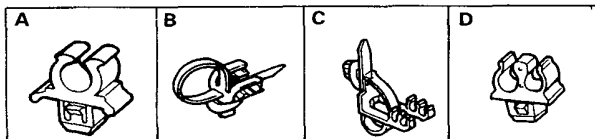

Electrical

Index to Circuits and Systems

Brake Lights

Brake Light Failure Sensor Test..16-9

Circuit Diagram16-8

Ground Distribution

Circuit Identification16-7

Power Door Locks

Circuit Diagram16-17

Component Location Index.....16-16

Control Unit Input Test.....16-19

Control Unit Input Test (cont'd) .16-20

Door Key Cylinder Switch Test ..16-23

Driver's Door Actuator Test16-21

Ignition Key Switch Test.....16-24

Passenger's Door Actuator Test .16-23

Tailgate Actuator Test16-22

Troubleshooting.....16-18

Rear Wiper/Washer

Circuit Diagram16-26

Component Location Index.....16-25

Wiper Motor Replacement16-28

Wiper Motor Test16-28

Washer Motors Test.....16-29

Wiper/Washer Switch Test16-27

Relay and Control Unit Locations

Floor and Door.....16-2

Stereo Sounds System

Circuit Diagram16-13

Component Location Index.....16-12

Power Antenna Motor Test16-14

Rear Speaker Replacement.....16-15

Tailgate Latch Switch

Test/Replacement16-10

Taillights

Replacement16-11

Wire Harness and Ground Locations

Floor.....16-3

Rear.....16-5

Rear Roof.....16-4

Tailgate16-6

Wiring Diagrams16-30

